

# PANTOUMAZI

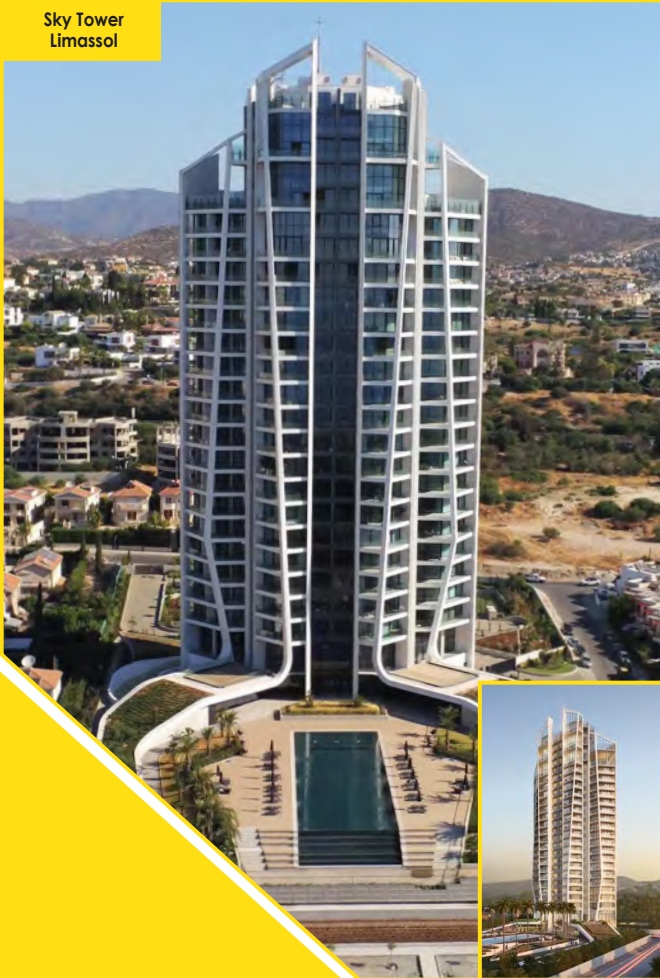

Sky Tower  
Limassol



Limassol Del Mar  
Limassol



Ararat Grand Residences  
Limassol



American University of Beirut  
Mediterraneo campus  
Paphos



Palisandro Hills  
Paphos



# CONTENT

p.1

**INTRODUCTORY** NOTE

p.2

**RECENTLY COMPLETED** PROJECTS

p.8

**PROJECTS** IN PROGRESS

p.17

**NEW** PROJECTS

p.20

**BOOK**

THE HISTORY OF CONSTRUCTION IN CYPRUS:  
FROM PREHISTORY TO THE 21ST CENTURY

p.25

**CONFERENCES** / PRESENTATIONS / EVENTS / SPONSORSHIPS

p.26

**STAFF**

# INTRODUCTORY NOTE



Dear **ATLAS PANTOU** friends and associates,

We always valued our relationship, and it is our strong belief that close and personal communication is very important especially in the field in which we operate.

As developments in our country progress, we believe by using the technology we can establish a more direct communication channel with you.

This is the reason we created the **ATLAS PANTOU** Newsletter.  
Following is our latest news for the period July to September 2022.

Kind regards,  
**ATLAS PANTOU**

1





# RECENTLY COMPLETED PROJECTS



## Harmony Residence, Limassol

**Project Description:** Harmony Residence is a gated apartment complex specifically designed to accommodate the expectations of homeowners who value a good quality of life and appreciate everyday modern comforts. The building consists of 18 stylish and modern 1, 2, and 3-bedroom apartments separated into 2 apartment blocks. Block A has 2 floors and 8 apartments. Block B has 3 floors with 8 apartments on the first 2 floors and 2 magnificent 3-bedroom penthouses with spacious roof terraces on the 3rd floor. Harmony Residence is located in the cross-roads of Ayias Fylaxeos and Spyrou Kyprianou (Makedonias Avenue), Kapsalos area.

The project was developed on behalf of **D. Sykopetrides Ltd.**

**Architects:** Elias Andronicou & Associates.

**QS:** A.Y. Toumazis Quantity Surveyors L.L.C

**Electromechanical Consultants:** Prime Design Consulting Engineers Ltd and M&Z Zindilis & Associates.



# 2

# RECENTLY COMPLETED PROJECTS



## MEDO B - Medochemie, Limassol

**Project Description:** Construction of a 2-storey microbiological MEDO B at Medochemie plant in Limassol. The building consists of a steel frame except for the staircases which will be made of concrete. The finishes of the external walls are a combination of fairfaced concrete and alucobond. Works also included the construction of a ground floor parking area.

The project was developed on behalf of **Medochemie Ltd.**

**Architects:** Akis Charalambous Architects

**Q.S.:** A.Y. Toumazis Quantity Surveyors LLC

**Electromechanical Consultants:** Hiteco engineering Ltd



3



# RECENTLY COMPLETED PROJECTS



## Private residence in Paniotis area in Germasogeia village

**Project Description:** A unique, luxurious around 1,200m<sup>2</sup> villa sitting on a plot of 2,900m<sup>2</sup>, with 6 bedrooms distributed harmoniously on the basement, ground floor and first floor, surrounded by beautiful sea and mountain views. Decorated with wood, stone and equipped with state-of-the-art technology, the villa is designed to blend in with the natural environment of the surrounding area. It features a private pool, elevator, fitness center, wine cellar, BBQ area, private drive through and extensively well-made outdoor landscaping.

**Architects and Electromechanical Consultants:** Vakis Associates Architects & Designers.

**QS:** A.G. Athanasiou



# RECENTLY COMPLETED PROJECTS



## BIOGENA – PHASE B' – NEW R&D, Limassol

**Project Description:** The works of the project consisted of demolition works of part of an existing building and construction of new premises. The new premises include new offices and labs. Works also included various road and other external works.

The project was developed on behalf of **MEDOCHEMIE LTD.**

**Architects:** Akis Charalambous Architects

**Q.S.:** A.Y. Toumazis Quantity Surveyors LLC

**Electromechanical Consultants:** Hiteco engineering Ltd





# RECENTLY COMPLETED PROJECTS



## Sky Tower, Limassol

**Project Description:** Luxury high-end apartments on a 23-store tower with hotel amenities developed with the latest architectural and design trends. Situated only 300m from the sea, the apartment owners can enjoy the vast amenities of the facilities that among others include incredible panoramic sea views, relaxing spa breaks, shared outdoor pool, heated indoor pool, fitness centre, tennis court, fantastic evergreen gardens surrounding the tower and spacious underground parking. Sky Tower rests harmoniously on the cityscape of the Limassol tourist area thanks to its magnificent design by one of London's leading architectural agencies. This 23-store challenging project has aluminium coating all over the outside. One of the remarkable things about this construction is that the floor slabs, unlike the conventional ones, are post-tensioned. The post-tensioned slabs are designed to provide active reinforcement, making the building blocks even more efficient in terms of stability and economy in building materials.

The project was developed on behalf of **Prime Property Group**.

**Architects:** UHA London and Panos Panayiotou & Associates, PPA.

**Q.S.:** PMI (Project Management International).

**Electromechanical Consultants:** Alexis S. Stavrou & Associates.

**Contractor:** Joint Venture between Atlas Pantou Co Ltd and Man Enterprise (Atlas Pantou - Man JV).





# RECENTLY COMPLETED PROJECTS



## New LIDL store in Ayios Athanasios, Limassol

**Project Description:** The works of the project included demolition works of all existing buildings and the construction of a new LIDL store of an internal area of around 2,200m<sup>2</sup> with a metallic roof of around 3% inclination, external thermal facade and shading at the entrance. External works included parking spaces with shades, road and sidewalk works around the perimeter of the store, installation of the various services and the configuration of a green area/park.

The project was developed on behalf of **Lidl Cyprus**.

**Architects:** Stamatoukos, J., Technical - Studies S.A.

**Q.S.:** Christos D. Ioannou Construction Cost Consultants LLC

**Electromechanical Consultants:** Dicom Services Ltd (Vrasidas Mavroudis)



7

# PROJECTS IN PROGRESS



## Limassol Del Mar, Λεμεσός

**Start date:** March 2018

**Project Description:** Developed less than 25m from the beach, on a plot of 34,000m<sup>2</sup> with its south side offering 170m of unobstructed sea views. Inspired by the gentle and curved waves of the Mediterranean in the south and from the low hills to the north, the unique sinusoidal curves of the project appear both in its center and on the floors with the curved walls creating a unique sculpture of approximately 40,000m<sup>2</sup>. Clearly influenced by nautical architecture, the building reflects a large cruise ship, with the outer gardens of the summit standing proudly as the bridge and the command station. The first construction phase involved the delivery of the first two towers (A and B), 13 and 18 floors respectively.



The second phase involved the delivery of the apartments of the "Signature Collection", that is the eastern tower of 28 floors.

Regarding the conclusion and delivery of the project, the first and second phase of the project along with the associated external works, are concluded and delivered.

Currently the works are concentrated on finishing the extra requested works on the second phase tower (easter tower).



**Developers:** Cypeir Properties Ltd (a partnership between Leptos Group and D. Zavos Group).

**Architects:** Benoy and UDS Architects Antoniadis & Eleftheriou.

**Electromechanical Consultants:** Unemec.

**Q.S.:** Christoforides Makris & Partners Ltd.

**Contractor:** AMIC Contractors (Joint venture between Atlas Pantou Co Ltd - leader, Man Enterprise, ICM Group, CMB Societa Cooperativa)



# PROJECTS IN PROGRESS



## Ararat Grand Residences, Limassol

**Start date:** December 2019

**Project Description:** Luxury high-end apartments on a 23-store tower with hotel amenities. The project is being developed along the beach road of Parekklisia area, in one of the most prestigious areas of Limassol. This unique high-rise building consists of only 17 luxurious apartments and a 5-floor penthouse. At road level there is a grand plaza leading to a gourmet restaurant, professional SPA, sauna, hammam, massage room, heated pool in a cave style enclosure, cigar lounge and a VIP bar for club members, wine cellar and jewellery boutique. At this level there is also a parking for residents as well as a separate parking for restaurant and commercial area visitors and guests. On the first floor there is the entrance lobby and reception on two levels. On the grounds of the complex (about 8.000 m2) there is a half-Olympic size (25x10m) mosaic swimming pool with a bar, tennis court, park, and a playground. The project's grounds are enclosed with a secure fence, and a 24-hour video surveillance.

The rest of the building consists of the following:

- 3rd and 4th floor: apartments.
- 5th floor: sauna and gym.
- 6th floor: Roman bath style heated indoor swimming pool with a bar – breakfast and recreation area.
- 7th -12th floor: apartments.
- 13th floor: Sky Garden, which is part of the restaurant on the next floor.
- 14th storey: a fine dining restaurant which has a separate elevator and parking area.
- 15th -18th floor: apartments.
- 19th-23rd floor: penthouse apartment with its own elevator and a swimming pool.

Regarding the progress of works, the earthworks, the foundation works as well as the columns and slaps of the main building are long concluded. Brick and coating works are also concluded. Currently the works are concentrated on the finishing works of the tower. Regarding the external works and the additional structural works including the parking area slap, the structural works are concluded, and the finishing works are progressing. The works regarding the façade cladding of the tower are also progressing.

The project is being developed on behalf of **Maserdo Ltd.**

**Architects:** Photiou Architects

**Q.S.:** A. Demetriades & Partners L.L.C.

**Electromechanical Consultants:** Primedesign Consulting Engineers Ltd.



# PROJECTS IN PROGRESS



## Acropolis Family Residences, Nicosia

**Start date:** December 2019

**Project Description:** A 6-storey apartment complex with 8 luxurious apartments. The project is being developed in the prestigious area of Acropolis in Nicosia. Apartment owners can enjoy a private swimming pool which will be located on the 1st floor.

Regarding the project completion and delivery, we currently applied for the certificate of practical completion and now the works concentrate on finishing the snagging list works.

The project is being developed on behalf of **Cyagama Ltd.**

**Architects:** Photiou Architects

**Q.S.:** A. Demetriades & Partners L.L.C.

**Electromechanical Consultants:** Primedesign Consulting Engineers Ltd.

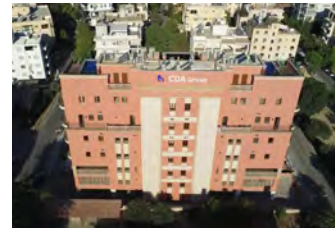

# PROJECTS IN PROGRESS



## Gardens Residence, Limassol

**Start date:** February 2020

**Project Description:** A gated complex of 8 luxurious villas with private swimming pools. The project is being developed in Agios Tychonas, Limassol. The first phase of the project includes the construction works for one villa along with the villa's private road services. The works regarding the villa are concluded including the installation of the lift. Moving towards the delivery of the 1st phase, the works on the villa are concluded and currently works concentrate on finishing the villa's private road and services.

The project is being developed on behalf of **ONDONIREA INVESTMENTS LTD.**

**Architects:** Lazarou & Michael Architects

**Q.S.:** MNP CQS (Marinos N. Panayiotides Chartered Quantity Surveyors)

**Electromechanical Consultants:** Alexis S. Stavrou & Associates





# PROJECTS IN PROGRESS



## Larnaca Sewerage & Drainage project C12A

**Start date:** February 2020

**Project Description:** The contract includes the investigation, management and cleaning up of trenches from antiquities, existing services, and any other obstacles in order to determine the final route of the future sewerage and drainage system. The project's estimated duration is 3 years.

The project is being executed on behalf of **LARNACA SEWERAGE & DRAINAGE BOARD**.





# PROJECTS IN PROGRESS



## Waterwork Vasilikos – Nicosia, Phase A': Construction of sub-project C1, Pipeline Nisou – Nicosia

**Start date:** September 2021

**Project Description:** This important sub-project is part of the large water project Vasilikos-Nicosia which aims to transport water from the Vasilikos Desalination Unit to Nicosia and will be a second major source of water supply in the wider Nicosia area. The contract includes the installation of malleable cast iron pipelines, 800mm and 700mm in diameter and total length of 17.2KM.

The works started by the highway exit towards the Kotsiatis village and already reached Tseriou avenue (area of Chalepianes). The works on Makedonias street towards the Lakatamia municipal swimming pool are also progressing. Around 8km of pipelines are already installed.

The project is being executed on behalf of the **Water Development Department**.

**Architects/Consultants:** Dion. Toumazis & Associates

Karavokyris, G., & Partners Consulting Engineers S.A.

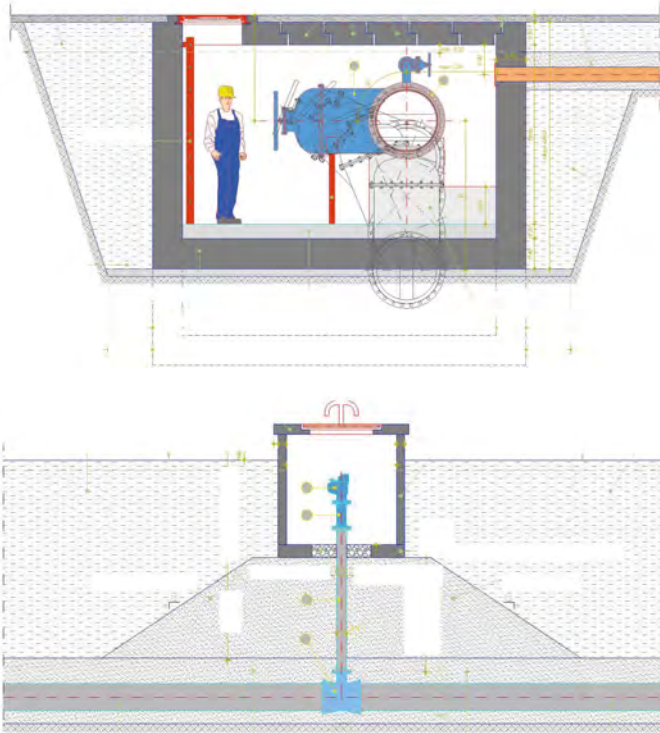

# PROJECTS IN PROGRESS



## Construction of flood protection works-contract F8, Limassol

**Start date:** January 2021

**Project Description:** The project is demarcated south of Makarios Avenue, east of the river Garyllis, west of Agias Zoni Street and north of Gladstonos and Navarinou Streets. The works include the construction of three main collectors for diverting rainwater to the Garylli riverbed. This is a project with an extremely high degree of difficulty, as it provides extensive excavation works on 27 streets in the center of Limassol, many of which are main commercial streets with increased traffic and commercial activity.



The works on Therissou, Vassilis Michailidis, Stavroforon, Ioustinou, Idaliou, Orfeos, Victor Hugo, Lanitis, Navarinou, Thessalonikis and Dodekanisou streets have been completed. Currently in progress are the works on Beyazit and Ayias Fylaxeos streets.

The project is being executed on behalf of **LIMASSOL AND AMATHOUNTA SEWERAGE & DRAINAGE BOARD**.

**Consultants (Study – Supervision):** Joint Venture: Z&A P. Antonaropoulos & Associates and ROIKOS Engineering Consultants SA

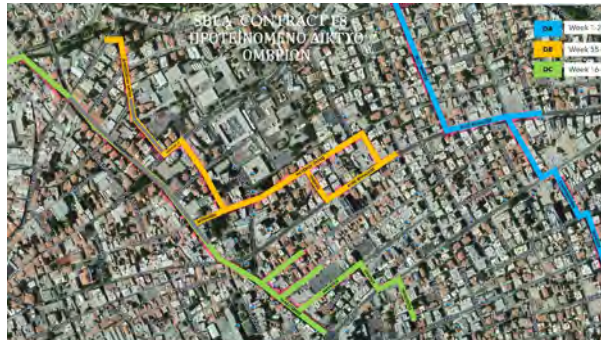



# PROJECTS IN PROGRESS



## Construction of the 'Neapolis Project' in Limassol

**Start date:** June 2022

**Project Description:** A five-storey residential building with 16 modern and stylish apartments of covered area around 2,500m<sup>2</sup>. The building has 6 levels (Ground floor, 1st floor, 2nd floor, 3rd floor, 4th floor, a roof garden) and a basement. The basement contains two storerooms, and the ground floor comprises 16 parking spaces. Each of the 4 floors has 4 apartments. The residents of this luxurious project can enjoy a private pool which is located at the roof garden. Part of the façade features ELVA aluminium cladding.

Regarding the progress of works, the works now include excavation and de-watering works (works required for the construction of the basement) as well as various other project related earthworks.

The project is being developed on behalf of **Swift Global Ltd.**

**Architects:** Panos Panayiotou + Associates

**Civil Engineer:** Advanced Civil Engineering Solutions

**Q.S.:** Efthymios Andreou & Associates Ltd

**M.E.P. (Mechanical, Electrical, Plumbing) Consultants:** K. Karantonis Partners LLC





# NEW PROJECTS



## Palisandro Hills, Paphos

**Start date:** September 2022

**Project description:** A club township consisting of 18 luxurious villas with private swimming pools and their associated road and other external works, including an orchard and a playground. Its design combines a careful attitude towards nature aiming at the same time to create an uncompromisingly comfortable living environment. The general arrangement of the built-up area features two lines of land plots along the valley, making good use of the height difference, recessing the villas located along the valley into the mountain in order to preserve the picturesque panoramic views from the villas situated on the western line.

Palisandro Hills is in Peyia village, Paphos. Its premium location next to a mountain river and a national park guarantees to future residents' spectacular views of the mountains and coastline.

The project is being developed on behalf of **INEX GROUP**.

**Architects:** Simpraxis Architects LLC

**QS:** MDA Cyprus LLC

**Electromechanical Consultants:** DoubleN Electrical Consulting Engineering LLC (Electrical) and Emech Engineering - Kikis Hadjifrangiskou (Mechanical)



## 17





# NEW PROJECTS

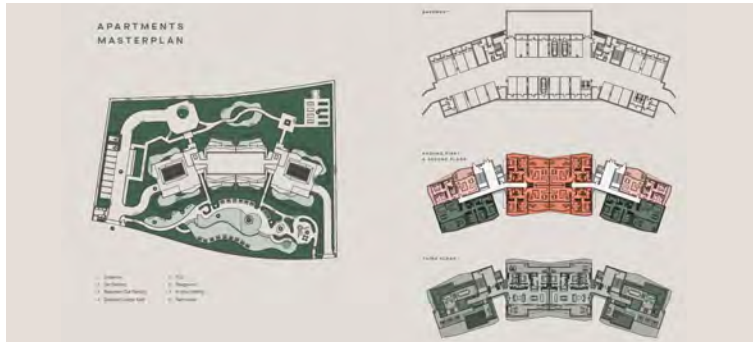

## Limassol Greens – Robin West Residential Building, Limassol

**Start date:** 2022

**Project description:** Limassol Greens is one of the largest master planned developments in the city of Limassol. AECOM, the world's premier infrastructure firm, designed a masterplan that ingeniously sets the residential and commercial units in the centre of the resort development, surrounding them with golf greens and fairways on all sides. Developed over an area of 1.4 million m2 Limassol Greens entails an 18-hole championship golf course with a state-of-the-art clubhouse, 500 villas and 250 apartments to be developed in phases, retail and commercial facilities including shops, restaurants, bars, a Wellness Centre with an outdoor pool, spa treatment facilities, fitness area, yoga and meditation lawns, tennis, basketball courts and cycleways, children's playgrounds, an open-air amphitheatre and a herb garden.

The Robin Apartments consist of two blocks set out over the ground floor and three storeys, served by two separate spacious lobby areas with their own lift. Located in the heart of the resort, within a minute's walk from The Village and The Clubhouse, the Robin Apartment buildings (there are 2 identical, Robin West and Robin East) are the only buildings tall enough to enjoy unparalleled views over the Golf Course and up to the Salt Lake, the forest and the sea. The chic and practical interiors combine carefully crafted layouts that work hard to maximise the interior spaces while ensuring the focus remains on the generous terrace and views beyond.

The project is being developed on behalf of **LANITIS GOLF PUBLIC CO LTD.**

**Architects:** J+A Philippou Architects Engineers

**QS:** Yioula Michaelidou - M.Y.QS Services LTD

**Electromechanical Consultants:** GEMAC Consultancy Services Ltd



# NEW PROJECTS

## American University of Beirut – Mediterraneo campus, Paphos

**Start date:** September 2022

**Project description:** The American University of Beirut (AUB) is one of the MENA (Middle East and North Africa) region's oldest and most prestigious institutions of higher education. It will be its first campus outside Lebanon.

The project consists of the construction of campus' Administration building, the Classrooms' building and the Auditorium & Facility building along with the associated external works.

The Administration building is located at the west front side of the developing plot adjacent to the main access road. It consists of the university administration staff and professors' offices with their services including an entrance lobby, vertical and horizontal circulations, elevators lobby, restrooms, pantries, electric/telecom rooms, a data centre, offices and meeting rooms. The building is distributed on a ground and 3 other floors with an overall gross building area of around 4,270 m<sup>2</sup>.

The Classrooms' building is located at the east back side of the developing plot. It consists of all the classrooms and spaces related to students with their services including an entrance lobby, vertical and horizontal circulations, elevators lobby, laboratories, study rooms, restrooms, electrical and telecom rooms. The building is distributed on a ground and 3 other floors with an overall gross building area of around 4,850 m<sup>2</sup>.

The Auditorium & Facility building is located adjacent to the Administration building at the south side of the developing plot. It consists of the campus' facilities and MEP (Mechanical, Electrical and Plumbing) spaces including the Auditorium, a snack bar, water tanks and pump rooms, storages, electrical main rooms, a generator, and maintenance staff offices. The building is distributed on a basement, a ground, and a mezzanine floor with an overall gross building area of around 2,100 m<sup>2</sup>.

The Administration and the Classrooms' buildings are linked with an open colonnade at ground level with an overall gross building area of around 425 m<sup>2</sup>. There is also an electrical sub-station and several storage areas with an overall gross building area of around 230 m<sup>2</sup> located under the bleachers between the Auditorium & Facility and Classrooms' buildings. The project is being developed on behalf of the **American University of Beirut**.

**Architects:** Dar Al-Handasah Consultants (Lebanon) and Antreas Ioannou Architects (local)

**QS:** N/A

**Electromechanical Consultants:** Dar Al-Handasah Consultants

**Contractor:** Joint Venture between Atlas Pantou Co Ltd and Man Enterprise (Atlas Pantou - Man JV).



# BOOK

## THE HISTORY OF CONSTRUCTION IN CYPRUS: FROM PREHISTORY TO THE 21ST CENTURY



Famagusta Municipality Library



Russian Cultural Center Library



TEPAK University



Limassol Public Library

The Atlas Pantou Group, boasting 80 years of history, is an important chapter of the construction industry in Cyprus. With respect for the art of construction, as well as our land and culture, two years ago it set a grandiose plan, to publish the first comprehensive book on the history of Construction in Cyprus, with the main goal of contributing to our island's culture.

The book "The History of Construction in Cyprus: From Prehistory to the 21st Century" unfolds just that, the history of Construction in Cyprus from the dawn of human civilisation to the 21st century.

A select group of 10 scientists-researchers, based on modern research on the history, archaeology, and architecture of Cyprus, has written down the raw materials, the techniques, and the construction forms in their diachronic course through the political, social, financial, and cultural changes on the island.

Abundantly illustrated and with a glossary of technical terms, this bilingual edition (greek and english) aspires to be an essential handbook for both experts and non-experts of the past and modern-day generation.

More information about the book can be found on our website [www.atlaspantougroup.com](http://www.atlaspantougroup.com) / **Who We Are / Our culture** or by clicking [HERE](#). Also, the book is **exclusively** available for anyone who wishes to purchase it through our website [www.atlaspantougroup.com](http://www.atlaspantougroup.com) / **Who We Are /Our Culture**, or by clicking [HERE](#).



# BOOK

## THE HISTORY OF CONSTRUCTION IN CYPRUS: FROM PREHISTORY TO THE 21ST CENTURY

Atlas Pantou Group started with the donation of the publication "The History of Construction in Cyprus: From Prehistory to the 21st Century" to the following libraries:

- ✓ University of Cyprus – Learning Resource Centre UCY Library "Stelios Ioannou"
- ✓ Library of TEPAK University
- ✓ Library of University of Nicosia
- ✓ Library of Frederick University
- ✓ Library of European University
- ✓ The Cyprus Institute
- ✓ Cyprus Library
- ✓ Elpinikios Library
- ✓ Library of the Department of Antiquities
- ✓ Russian Cultural Center Library
- ✓ Achillios Municipality Library
- ✓ Archeological Research Library
- ✓ Press & Information Office Library
- ✓ Municipal Art Centre Library
- ✓ Library KEBE (Cyprus Chamber of Commerce and Industry Library)
- ✓ Cyprus Productivity Center (CPC) - Mediterranean Institute of Management Library
- ✓ CYS: Cyprus organization for Standardization Library (CYS)
- ✓ Cyprus-American Archaeological Research, Institute Library (CAARI)
- ✓ Limasol Public Library
- ✓ Strovolos Municipality Library
- ✓ Famagusta Municipality Library

ATLAS PANTOU will also proceed with the donation of the book to libraries/ university libraries abroad.

# BOOK

## THE HISTORY OF CONSTRUCTION IN CYPRUS: FROM PREHISTORY TO THE 21ST CENTURY

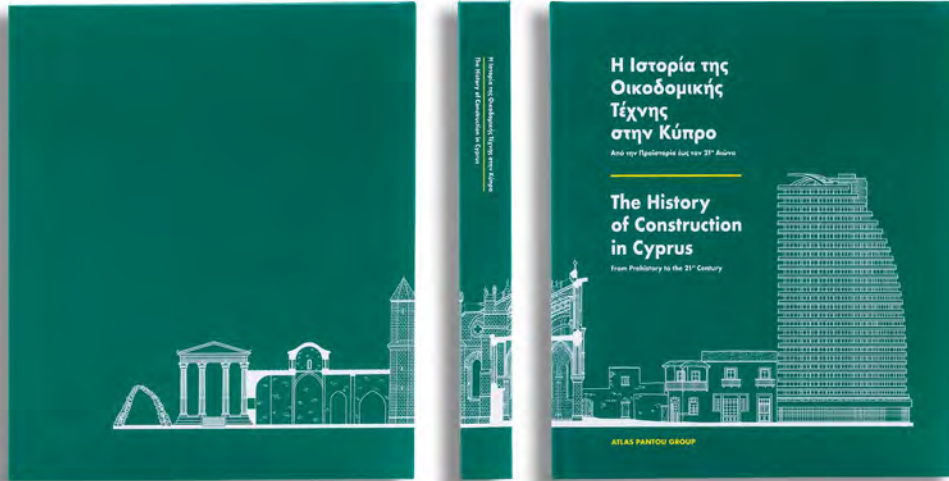

### Foreword by Mr. Tonis Toumazis, Founder of ATLAS PANTOU Group

From cave dwelling to the first stone and timber structures, from clay to concrete and iron, man has not stopped evolving. Once, in the distant past, we gazed at the skyline from the port of ancient Salamis. Today we gaze at it from the balconies of skyscrapers, watching merchant ships, cruise ships, and hydrocarbon mining platforms plough the seas of our island.

As a businessman and civil engineer, I have always admired the art and science of building. Universities taught me how to methodically apply its techniques and principles, but it was my father, Panayiotis Toumazis who taught me its moral code.

Many years ago, in 1937, he established his first construction office in Famagusta. This

would be the cornerstone of the construction company that followed and the group of companies that developed later on.

The journey throughout the years has proven very challenging. The 1974 Turkish invasion inevitably affected the companies of the group, leading some of them to near closure. We lost Famagusta and our properties, yet we never lost the courage to continue, nor the ability to maintain the development of our expertise. After taking over the management of the company in 1987, with consistency, persistence and immeasurable hard work from all the personnel, we managed to transform the company into a highly regarded and well-respected group by the name of Atlas Pantou.

From prehistoric times to the present, the building techniques that have been adopted in Cyprus have played a major role in the development of our quality of life; they have contributed to the local population's survival, evolution and progress, even shaping our culture.

# 22



# BOOK

## THE HISTORY OF CONSTRUCTION IN CYPRUS: FROM PREHISTORY TO THE 21ST CENTURY



The aim of this study was to record and publish the history of the art of building in Cyprus, from ancient to modern times. This publication provides a fascinating insight into this aspect of our culture, and is an invaluable source of knowledge of our building heritage from its origins up to the present day.

The book entitled 'The History of Construction in Cyprus: From Prehistory to the 21st Century' is Atlas Pantou's offering to our country, its people and its culture. We deem it to be a project of timeless value, as it documents and showcases our cultural heritage relating to construction. This is our way of contributing to the acknowledgement, recording and promotion of thousands of years of human inventiveness and creativeness that is evidenced by a variety of buildings and structures that adorn our land. I would like to sincerely thank all the authors, contributors and generally anyone who helped in any way to "build" this publication.



# BOOK

## THE HISTORY OF CONSTRUCTION IN CYPRUS: FROM PREHISTORY TO THE 21ST CENTURY



Mr. Tonis Toumazis, founder of the ATLAS PANTOU and ATLAS PANTON groups, had the pleasure and honour of donating the book 'The History of Construction in Cyprus: From Prehistory to the 21st century' to the Senator from New Jersey and Chairman of the Senate Foreign Relations Committee, Robert Menendez, during his recent visit in Cyprus.

Atlas Pantou group donated the book "The History of Construction in Cyprus: From Prehistory to the 21st Century" to the Cyprus Association of Civil Engineers (CYACE). The book was received on behalf of the Association by its president Mr. Andreas Theodotou.





# CONFERENCES / PRESENTATIONS / EVENTS / SPONSORSHIPS



## MAJOR SPONSOR OF RIALTO THEATRE

Since September, ATLAS PANTOU is one of the 'Major Sponsors' of the Rialto Theatre. For 23 years, Rialto Theatre has been a Cultural Organization that produces and manages culture through a wide range of theatrical performances and various other cultural activities. Its mission is to create suitable conditions for the production and promotion of culture, through education and entertainment, aiming at the development of a modern and human-centered society.

By supporting the activities of Rialto Theatre, ATLAS PANTOU aims to strengthen this production and development of modern culture, in an effort to contribute to a better future for the country and its people.

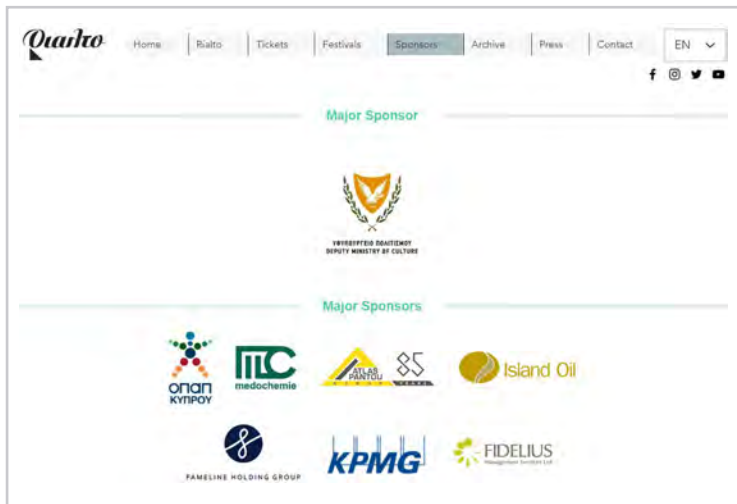

25

# STAFF

## STAFF TRAINING



Our people are our most valuable and important asset, this is why we invest in educating our staff in every level.

As a company based on its employees, we always want to offer the best possible sources of knowledge and development to all of our staff members.

Within the framework of our modernization and development policies, we have launched a number of innovative programs, designed and implemented since the

beginning of the year. Education plays a vital role for us, since without it we wouldn't be able to achieve our goals.

With faith in our human-centric character and deep trust to our staff we will continue our mission: always evolving through the knowledge of our people.

Here are some of the most important staff training courses for July 2022 until September 2022:

- **FIRST AID IN THE WORKPLACE**
- **TRAINING FOR HEALTH & SAFETY OFFICERS**
- **'SUPERVISION AND IMPLEMENTATION OF AN INTEGRATED WASTE MANAGEMENT PLAN FOR CONSTRUCTION AND TECHNICAL PROJECTS' SEMINAR**

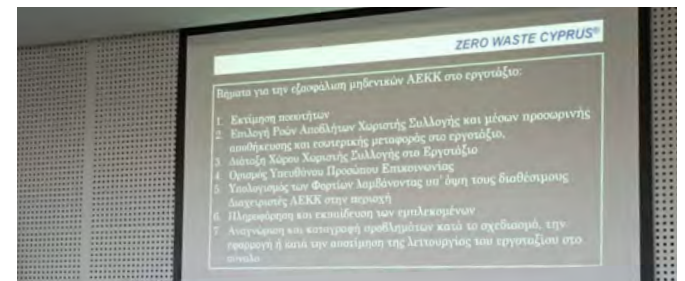



# STAFF



## Our team is growing!

We are pleased to introduce the latest members of our company, selected among many candidates, because they share the same mindset and values as us.

We welcome and greet them with a smile:

- **Polykarpou Charalambos / Site Engineer**
- **Demetriou Petros / Site Engineer**
- **Konstantinou Konstantinos / Site Engineer**
- **Charalambous George / Land Surveyor Assistant**
- **Theodosiou Antonis / Foreman**
- **Daniel Christoforos / Foreman**
- **Konstantinou Giannakis / Foreman**
- **Christou Sotiris / Foreman**
- **Giallourous Charalambos / Foreman**
- **Stavrou Charalambos / Foreman**
- **Michael Michalis / Foreman**
- **Nikolaou Sotiris / Accounting department**